

Year 5 Knowledge Organiser – Bridges



Key Facts:

Forces can change the shape of objects, they can also make objects begin to move, speed up or slow down.



Pulls and pushes are both forces.

Gravity is a force which pulls everything towards the centre of the Earth. The weight of something is the force that the Earth's gravity is having on it.

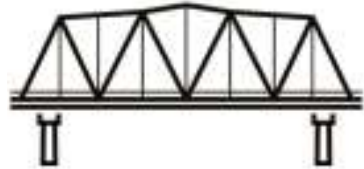

Truss Bridge



Suspension bridge



Beam bridge



Arch bridge

Key Vocabulary:

Continued

Structure - Something which stands, usually on its own.

Suspension bridge - A bridge which is supported by vertical cables and suspended by cables which run between pillars that are connected onto either end of the bridge.

Tenon saw - A saw with a flat blade, used for cutting wood in straight lines or angles.

Tension - A stretching force caused by two parts of a structure being pulled apart.

Truss bridge - A bridge which is built from a series of triangular beams.

Key Vocabulary:

Accurate - Neat, correct shape, size and pattern with no mistakes.

Arch bridge - A bridge which is built with a curved arch.

Beam bridge - A bridge which is built with horizontal beams and vertical pillars.

Bench hook - A tool which hooks onto the edge of the workbench. It's used to hold woodwork still when sawing.

Compression - A squashing force caused when parts of a structure are pushed together.

Coping saw - A saw with a narrow D-shaped metal blade, used for cutting curves in wood.

File - A tool used to smooth down rough edges on wood or metal materials.

Mark out - To measure and mark where a piece of material needs to be cut or shaped.

Reinforce - To make a structure or material stronger, especially by adding another material or element to it.

Sand paper - Strong paper with sand on one side to smooth or polish woodwork.

Set square or Try square - A right-angle triangular plate, wood or metal tool used for drawing lines at 90°, 45°, 60°, or 30°.

Shape - The form of an object.